

## SV8100 PGD General Purpose Relay to control External Slave Relay

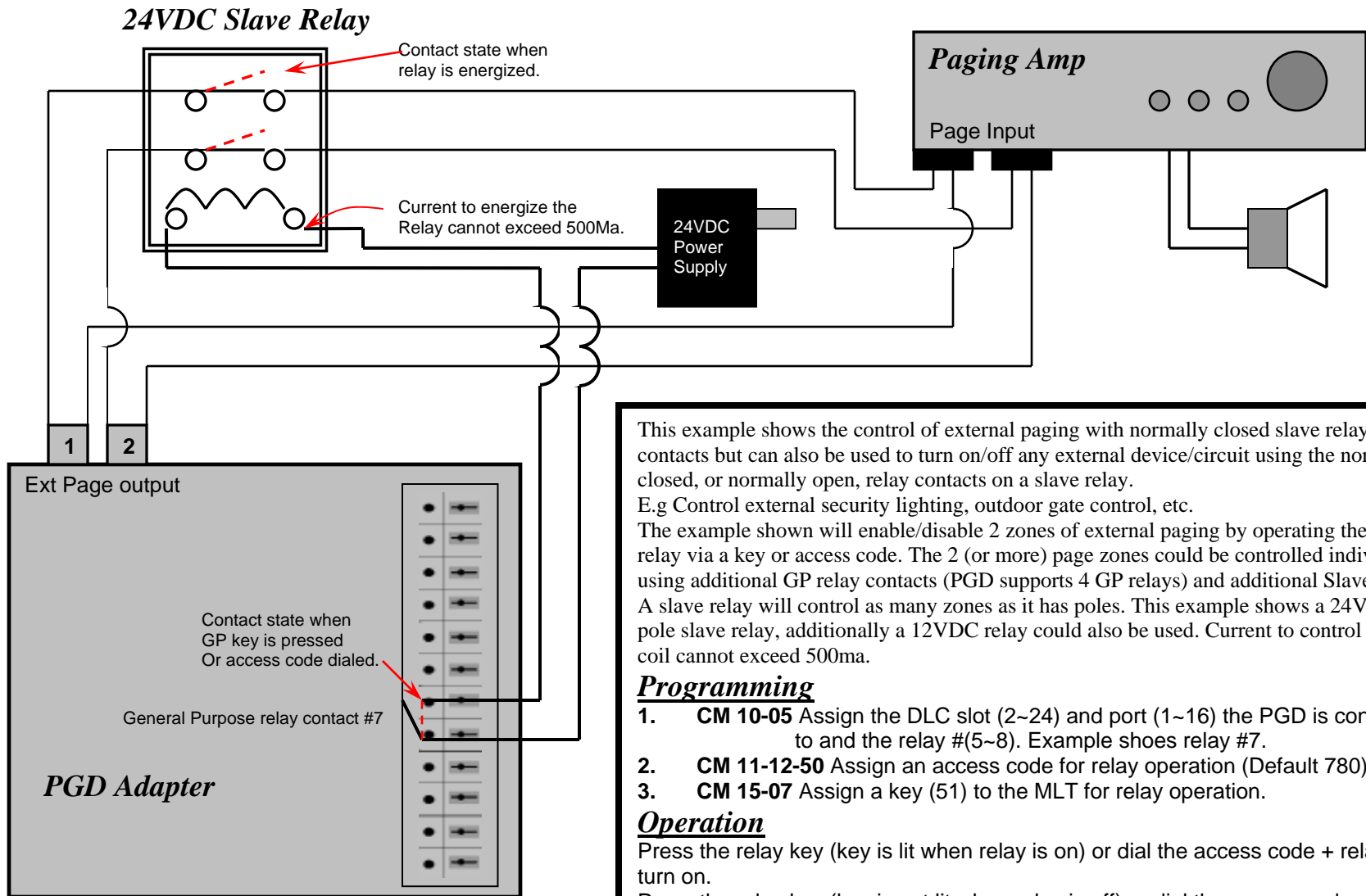

This example shows the control of external paging with normally closed slave relay contacts but can also be used to turn on/off any external device/circuit using the normally closed, or normally open, relay contacts on a slave relay.  
 E.g Control external security lighting, outdoor gate control, etc.

The example shown will enable/disable 2 zones of external paging by operating the GP relay via a key or access code. The 2 (or more) page zones could be controlled individually using additional GP relay contacts (PGD supports 4 GP relays) and additional Slave Relays. A slave relay will control as many zones as it has poles. This example shows a 24VDC two pole slave relay, additionally a 12VDC relay could also be used. Current to control the relay coil cannot exceed 500ma.

**Programming**

1. **CM 10-05** Assign the DLC slot (2~24) and port (1~16) the PGD is connected to and the relay #(5~8). Example shoes relay #7.
2. **CM 11-12-50** Assign an access code for relay operation (Default 780).
3. **CM 15-07** Assign a key (51) to the MLT for relay operation.

**Operation**

Press the relay key (key is lit when relay is on) or dial the access code + relay # to turn on.

Press the relay key (key is not lit when relay is off) or dial the access code + relay # to turn off. MLT display will confirm relay state upon on or off operation.